

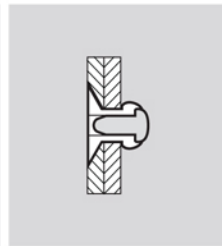

Aluminium [AlMg2,5/3,5]
Polished

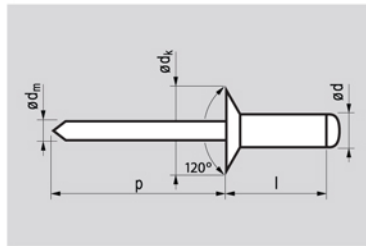

Steel
Zinc plated



open type | countersunk head

Ø d	l		Item nr.	Ø dk	k	Ø dm	p		
[mm]	[+1/-0,2]	[mm]		[mm]	[mm]	[mm]	[mm]	[N]	[N]
2,4	6,0	2,0-4,0	10342406	5,0 [+0/-0,4]	-	~1,45	≥27	355	315
[+0,08/-0,10]	8,0	4,0-6,0	2408						
Ø 2,5	10,0	6,0-8,0	2410						
3,0	6,0	1,5-3,5	10343006	6,0 [+0/-0,4]	-	~1,75	≥27	810	620
[+0,08/-0,10]	8,0	3,5-5,5	3008						
Ø 3,1	10,0	5,5-7,5	3010						
Ø 3,1	12,0	7,5-9,5	3012						
3,2	6,0	1,5-3,5	10343206	6,0 [+0/-0,4]	-	~1,75	≥27	980	760
[+0,08/-0,10]	8,0	3,5-5,5	3208						
Ø 3,3	10,0	5,5-7,5	3210						
Ø 3,3	12,0	7,5-9,5	3212						
Ø 3,3	14,0	9,5-11,5	3214						
4,0	6,0	1,5-3,0	10344006	7,5 [+0/-0,5]	-	~2,10	≥27	1.600	1.200
[+0,08/-0,15]	8,0	3,0-5,0	4008						
Ø 4,1	10,0	5,0-6,5	4010						
Ø 4,1	12,0	6,5-8,6	4012						
Ø 4,1	14,0	8,5-10,5	4014						
Ø 4,1	16,0	10,5-12,5	4016						
4,8	8,0	3,0-4,5	10344808	9,0 [+0/-0,5]	-	~2,70	≥27	2.230	1.690
[+0,08/-0,15]	10,0	4,5-6,0	4810						
Ø 4,9	12,0	6,0-8,0	4812						
Ø 4,9	14,0	8,0-10,0	4814						
Ø 4,9	16,0	10,0-12,0	4816						
Ø 4,9	18,0	12,0-14,0	4818						
Ø 4,9	20,0	14,0-16,0	4820						
Ø 4,9	25,0	18,0-21,0	4825						
5,0	8,0	3,0-4,5	10345008	9,0 [+0/-0,5]	-	~2,70	≥27	2.500	2.000
[+0,08/-0,15]	10,0	4,5-6,0	5010						
Ø 5,1	12,0	6,0-8,0	5012						
Ø 5,1	14,0	8,0-10,0	5014						
Ø 5,1	16,0	10,0-12,0	5016						
Ø 5,1	18,0	12,0-14,0	5018						
Ø 5,1	21,0	14,0-17,0	5020						
Ø 5,1	25,0	17,0-20,0	5025						



Blind rivets