

CHANNEL BRACKET

Specification:	BS 6946:1988
Finishing:	hot dip galvanized to ISO 1461:1999

Square Washer
Item No. M6946F01 (Φ10)
M6946F02 (Φ12)
M6946F03 (Φ14)

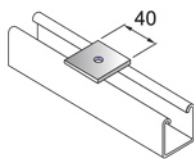

Rectangular Plate (2 holes)
Item No. M6946F04

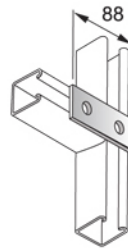

Rectangular Plate (3 holes)
Item No. M6946F05

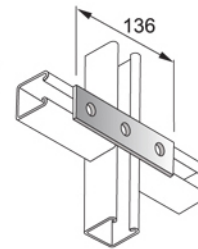

Rectangular Plate (4 holes)
Item No. M6946F06

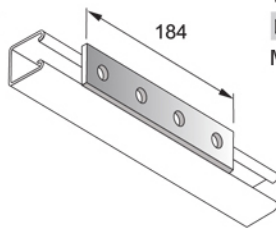

Flat Angle Bracket
Item No. M6946F07

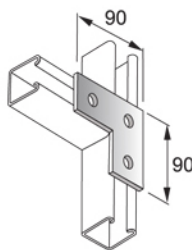

Tee Bracket
Item No. M6946F08

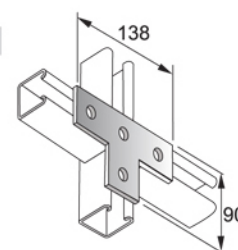

Angle Bracket (41x57 / 2 holes)
Item No. M6946A01

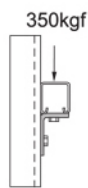
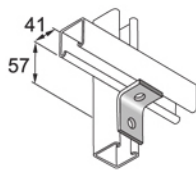

Angle Bracket (50x47 / 2 holes)
Item No. M6946A02

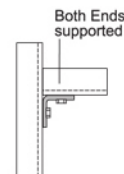
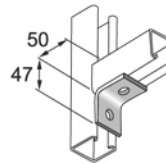

Angle Bracket (4 holes)
Item No. M6946A04

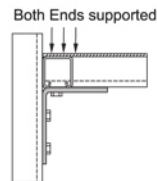
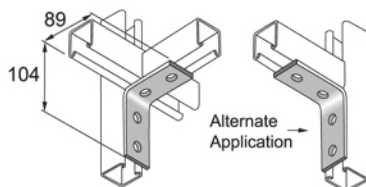

Angle Bracket (3 holes)
Item No. M6946A03

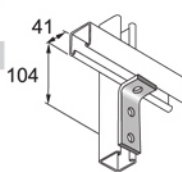

FLOOR BRACKET

41x41 Single Base Plate (Light Duty)
Item No. M6946B01

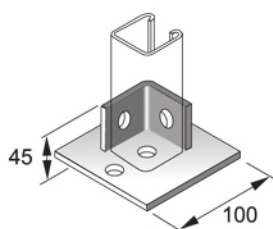

41x41 Double Base Plate (Light Duty)
Item No. M6946B02

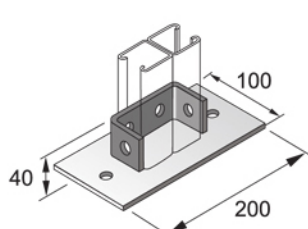

41x41 Single Base Plate (Heavy Duty)
Item No. M6946B03

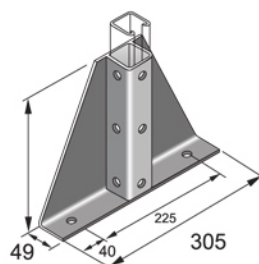

41x41 Double Base Plate (Heavy Duty)
Item No. M6946B04

